

## **West Kensington Design District Announces Programming for London Design Festival 2018**

**July 2018 - The inaugural West Kensington Design District is set to be the must-visit destination of London Design Festival 2018 with an exciting line-up including the newly opened Japan House, Design Museum, V&A Blythe House, 100% Design and more.**



*Olympia London Renovation*

Returning for its 24th edition, **100% Design** will take place from 18-22 September. With new features 100% Forward and 100% Futures, and an exciting roster of established and emerging brands the show promises to be an unmissable destination during the London Design Festival.

**Olympia London**, home to 100% Design, is undergoing a major regeneration project, managed by owners **Yoo Capital** and Deutsche Finance International. Working with world-renowned design studio **Heatherwick Studio** and the award-winning **SPPARC architects**, the project will see the 130-year-old venue based on a 14 acre site in Kensington, London, transformed into a world-leading arts, entertainment, event and experiential district whilst staying true to its original heritage as an events business. At 100% Design, within the Upper Pillar Hall, Olympia London will host an historical exhibition of the iconic venue and showcase the vision for the next 130 years.

This year, as part of a refreshed programme the show welcomes **Thomas Heatherwick** and **Marcel Wanders** to the infamous *Talks with 100% Design*. Alongside an array of leading names and industry

insiders, expect a series of inspiring sessions reflecting the very best in global design, emerging talents and the changing landscape of London's creative communities.

During the festival, Olympia will also be home to **Design Best** – a concept store offering discounts from our favourite design brands; from lamps to bags, homewares and fashion. In one of the traditional and exclusive reception rooms of Olympia, **Enlightened by Design III** will present a lighting exhibition from Dutch curator **David Heldt** showcasing work from Dutch design studios, including **Margaret van Bekkum, Marc de Groot, Jacqueline Harberink, Alex Groot Jebbink and Jesse Visser.**



V&A Blythe House

Home to the V&A's study and research centre, **Blythe House** will run a series of tours during the festival. Visitors can book onto one of four tours from 19-21 September to experience the V&A's Clothworkers' Centre which holds one of the world's most important collections of textiles and fashion; a chance to see the V&A's vast archives including theatre costumes, model boxes and more than 14,000 pieces of furniture and objects from Britain, Europe and America, dating from the Middle Ages to the present day.

Opened in June this year, **Japan House** is the new cultural home of Japan in London. Presenting the very best of Japanese art, design, gastronomy, innovation, and technology, it deepens our appreciation of all that Japan has to offer. With a wide-ranging programme, Japan House celebrates Japan's innovative, creative and technological merits, while shining a spotlight on the artisans, craftsmen, designers, performers, musicians and other professionals who are making waves both in Japan and around the world – from internationally renowned individuals, to emerging artists who are excelling in their field. For the London Design Festival, Japan House introduces *BIOLOGY OF METAL: METAL CRAFTSMANSHIP IN TSUBAME SANJŌ*, exploring the metal manufacturing tradition

of Tsubame Sanjō in northern Japan. Visit Japan House for the exhibition, a range of talks, demonstrations and workshops between 6 September and 28 October 2018.



*Design Museum*

The **Design Museum** – recently voted European Museum of the Year – will open its doors to new exhibitions and a series of events throughout the festival. Now in its eleventh year, *Beazley Designs of the Year* is the Design Museum's annual celebration of the most original and exciting products, concepts and designers in the world today. The international awards and exhibition showcases design projects from the previous 12 months, across six categories: Architecture, Digital, Fashion, Product, Graphics, and Transport. Exploring the notion of '*Belonging*', Curator at Large **Ammena M. McConnell** will curate a series of events and has commissioned the museum's atrium installation by London-based spatial laboratory **Loop.ph**. Visitors can also explore '*Re-considering Canon*' an exhibition curated by **Gallery FUMI** and the MA in Curating Contemporary Design at Kingston School of Art, that explores ideas around selection and collecting within curation.

Located in a converted church in West Kensington, **Arthill Gallery** exhibits Asian and European Contemporary art by established as well as emerging artists. For London Design Festival, **Arthill Gallery** will present an exhibition presenting research and development of *FiDU technology* through the presentation of a series of design objects including the iconic *PLOPP* stool designed by **Oskar Zieta** and manufactured by his own founded factory.

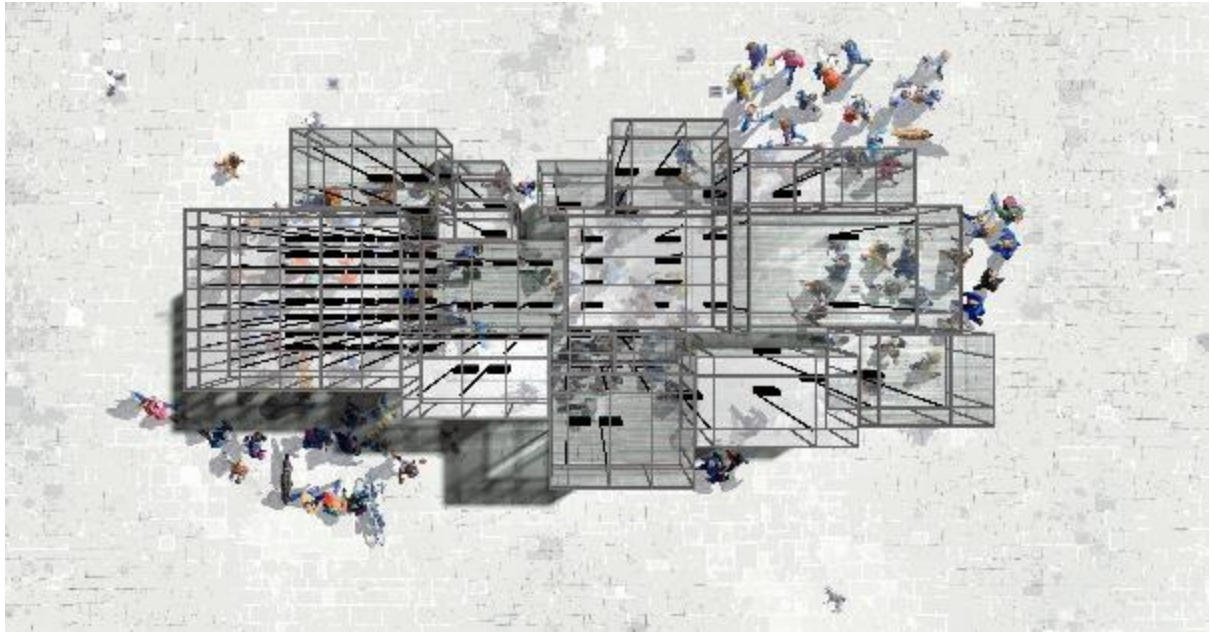

*Space Gap*

**Space Gap**, a pavilion set in front of Olympia, aims to explore the disparity of space allocation in London through a programme of events over the course of the London Design Festival. Design and social issues from homelessness to ghost mansions are tackled through immersive installations, film screenings, performances, talks, debates and in the pavilion design itself.

[www.westkensingtondesigndistrict.com](http://www.westkensingtondesigndistrict.com)

#### **Notes to editors**

The newly formed West Kensington Design District brings together leading design destinations, cultural institutions and must-see events during London Design Festival this September. The affluent area will be brought to life by a stellar array of partners and will be unmissable for design enthusiasts.

Discover an exciting programme of exclusive content curated by partners including Olympia London, 100% Design, Design Museum, Television Centre, Japan House and Arthill Gallery. Take part in exclusive tours of the V&A Archive at Blythe House plus much more.

The district late night will take place on Thursday 20<sup>th</sup> September

#### **100% Design**

Olympia London, Hammersmith Rd, Hammersmith, London W14 8UX

Opening Times:

19-22 September

10.00 – 17.00, late night opening Thursday until 21.00

Public opening: 22 September

[www.100percentdesign.com](http://www.100percentdesign.com)

#### **Arthill Gallery**

Arthill Gallery, Ground Floor, Lourdes Apartments, North End Road, London W14 9NU

Opening Times:

17-23 September

Monday 17: 18.00 - 21.00

Tuesday 18, Wednesday 19, Friday 21, Saturday 22: 10.00 – 20.00

Thursday 20: 10.00 – 22.00

Sunday 23: 10.00 – 18.00

[www.arthillgallery.com](http://www.arthillgallery.com)

### **Design Best**

The London Room, Olympia London, Hammersmith Rd, Hammersmith, London W14 8UX

Opening Times:

19-22 September

10.00 – 17.00, late night opening Thursday until 21.00

[www.design-best.co.uk](http://www.design-best.co.uk)

### **Design Museum**

224-238 Kensington High Street, London, W8 6AG

Opening Times:

15-23 September

10.00 - 18.00, last admission 17.00

[www.designmuseum.org](http://www.designmuseum.org)

### **Enlightened Design III**

Olympia Room, Olympia London, Hammersmith Rd, Hammersmith, London W14 8UX

Opening Times:

19-22 September

10.00 – 18.00, late night opening Thursday until 21.00

Public opening: 22 September

[www.thedots.nl/enlightened-design-iii](http://www.thedots.nl/enlightened-design-iii)

### **Japan House**

101-111 Kensington High Street, London W8 5SA

Opening Times:

Monday to Saturday: 10:00 - 20:00

Sunday: 12:00 - 18:00

[www.japanhouselondon.uk](http://www.japanhouselondon.uk)

### **Olympia London**

Upper Pillar Hall, Olympia London, Hammersmith Rd, Hammersmith, London W14 8UX

Opening Times:

19-22 September

10.00 – 18.00, late night opening Thursday until 21.00

Public opening: 22 September

[www.olympia.london](http://www.olympia.london)

### **Space Gap**

Olympia London, Hammersmith Rd, Hammersmith, London W14 8UX

**Opening Times:**

**V&A Blyth House**

OXQ, 23 Blythe Rd, London W14 0QX

Opening Times:

Wednesday 19: 14.00-15.00 - Behind the scenes at the V&A's Clothworkers' Centre

Thursday 20: 14.00-15.00 - Tour of the V&A Archive of Art & Design and Theatre & Performance archives

Friday 21: 11.00-12.00: Tour of the V&A Furniture & Woodwork Archives

14.00-15.00: Blythe House Highlights

[www.vam.ac.uk](http://www.vam.ac.uk)

**Press Contacts**

Camron PR

7th Floor, 17 Slingsby Place

London, WC2E 9AB

E: [100percentdesign@camronpr.com](mailto:100percentdesign@camronpr.com)

Tel: +44 (0)20 7420 1700

[www.camronpr.com](http://www.camronpr.com)

**For press enquiries:**

Francesca Formenti

[Francesca.Formenti@camronpr.com](mailto:Francesca.Formenti@camronpr.com)

Charlotte Kaplan

[Charlotte.Kaplan@camronpr.com](mailto:Charlotte.Kaplan@camronpr.com)

Rachael Jevons

[Rachael.Jevons@camronpr.com](mailto:Rachael.Jevons@camronpr.com)

Dharine Surenthiran

[Dharine.Surenthiran@camronpr.com](mailto:Dharine.Surenthiran@camronpr.com)

**For general image requests:**

Francesca Formenti

[Francesca.formenti@camronpr.com](mailto:Francesca.formenti@camronpr.com)